

# SHOYEIDO

Traditional Japanese Incense - "Koh"

2026 Catalog



— Kyoto — Osaka — Tokyo — Yokohama — Sapporo — Boulder —



## SHOYEIDO

Since our establishment in the early 18th century, Shoyeido has worked diligently to perfect the art of manufacturing Japanese incense, also known as "Koh".

We offer a wide variety of unique and hand-blended scents for every occasion.

Our slogan, "Life with Fragrance" is meant to convey how incense can be a companion to the many activities in our day-to-day live. Our products are made mainly from natural ingredients. We believe it is not only our responsibility to appreciate and protect these generous gifts of nature, but also to preserve the traditions of incense blending that have been passed down from generation to generation.



## GIFT OF NATURE

Natural ingredients such as agarwood, sandalwood, cinnamon, clove, star anise — to name a few — are not indigenous to Japan. We work closely with many countries to gather these items and to protect the ecological integrity of all natural components in our incense recipes.

We believe it is not only our responsibility to appreciate and protect these generous gifts of nature, but also to preserve the traditions of incense blending that have been passed down from generation to generation.

Shoyeido products are produced with the greatest care so our customers can enjoy the highest quality of incense.

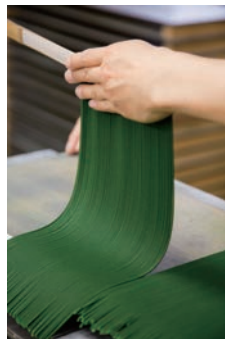

## TEN VIRTUES OF KOH

- It brings communication with the transcendent.
- It refreshes mind and body.
- It removes impurity.
- It brings alertness.
- It is a companion in solitude.
- In the midst of busy affairs, it brings a moment of peace.
- When it is plentiful, one never tires of it.
- When there is little, still one is satisfied.
- Age does not change its efficacy.
- Used everyday, it does no harm.

感格鬼神  
清淨身心  
能除污穢  
能覺睡眠  
靜中成友  
塵裏偷閑  
多用無障  
久藏不朽  
寡而為足  
多而不厭

Discover SHOYEIDO >>



# PREMIUM INCENSE



A highly skilled artisan makes most exclusive incense by hand. Made from centuries-old recipes and containing fine ingredients.

## Production of Premium Incense



For more information



**Myokaku**  
— Enlightenment  
Pure, dignified.

**111006 JPY 22,000** (20,000)

Approx. 36 sticks, 18 cm

**111020 JPY 6,600** (6,000)

15 sticks, 11 cm

★ Limited Availability

## ★ Limited Availability

The finest quality Agarwood is becoming increasingly rare and the reliable supply will be difficult in the future. To monitor the production of our premium incenses, and with respect to the environment of nature, the amount of production of our premium incense is limited.



**Gaho**  
— Refinement  
Splendor, elegance.

**110606 JPY 11,000** (10,000)

Approx. 36 sticks, 18 cm

**110620 JPY 3,300** (3,000)

15 sticks, 11 cm

★ Limited Availability



**Nankun**  
— Southern Wind  
Warmth, rejoicing.

**110506 JPY 6,600** (6,000)

Approx. 36 sticks, 18 cm

**110520 JPY 2,200** (2,000)

15 sticks, 11 cm

★ Limited Availability



**Misho**  
— Gentle Smile  
Happiness, understanding.

**110406 JPY 4,400** (4,000)

Approx. 36 sticks, 18 cm

**110420 JPY 1,870** (1,700)

20 sticks, 11 cm



**Shunyou**  
— Beckoning Spring  
Lush, tranquility.

**110306 JPY 3,300** (3,000)

Approx. 36 sticks, 18 cm

**110320 JPY 1,430** (1,300)

20 sticks, 11 cm



**Kyojiman**  
— Pride of Kyoto  
Quietude, affection.

**110206 JPY 2,200** (2,000)

Approx. 36 sticks,

18 cm



**Ohjya-koh**  
— King's Aroma  
Confidence,  
harmony, use anytime.

**110106 JPY 1,650** (1,500)

Approx. 36 sticks,

18 cm



**Matsu-no-tomo**  
— Friend of Pine  
Recollection, strength.

**120106 JPY 1,320** (1,200)

Approx. 36 sticks,

18 cm

# sui

*chic-refine-essence*

“粹 -sui” is a word that is used to express a Japanese aesthetic sense.

You may find “sui” in one’s sophisticated attitude, elegant appearance, or refined beauty.

It can also refer to the “essence” of things.

We invite you to embrace Shoyeido’s “sui” through chic fragrances, appearance, and the modest smoke of incense.



TRAY ▶P.15 Incense Tray Black



Use a proper incense tray made from heat-resistant material to catch ash.



### sui No.33

Blend: sandalwood, cinnamon, patchouli

121776 JPY 418 (380)



### sui No.35

Blend: cinnamon, clove, benzoin

121777 JPY 418 (380)



### sui No.71

Blend: patchouli, sandalwood, floral

121778 JPY 418 (380)



### sui No.75

Blend: sandalwood, clove, benzoin

121779 JPY 418 (380)



### sui No.99

Blend: sandalwood, patchouli, benzoin

121780 JPY 418 (380)

### Common Contents

1 scent  
Stick incense (L:135mm) 14g  
1 incense holder

★ EXPORT-ONLY



## Seifu — Fresh Breeze

Fresh Breeze refreshes your body and soul.

**123305** **JPY 13,200** (12,000)  
Short, loose, 490 sticks, 13.5 cm

**123308** **JPY 4,620** (4,200)  
Short, loose, 165 sticks, 13.5 cm



## Enmei — Circle

A circle is often drawn as an object of enlightenment. Please enjoy the essence of a circle with this subdued fragrance.

**123105** **JPY 8,800** (8,000)  
Short, loose, 490 sticks, 13.5 cm

**123108** **JPY 3,300** (3,000)  
Short, loose, 165 sticks, 13.5 cm



## Hakuun

— White Cloud

A fragrance inspired by the image of white clouds in a blue sky. High quality natural ingredients are blended to create this subtle scent.

**122905** **JPY 6,600** (6,000)  
Short, loose, 490 sticks, 13.5 cm

**122908** **JPY 2,530** (2,300)  
Short, loose, 170 sticks, 13.5 cm



## Gozan

— Five Hills

A mellow and deep fragrance, based on the best sandalwood available from Mysore, India.

**122705** **JPY 3,850** (3,500)  
Short, loose, 490 sticks, 13.5 cm

**122708** **JPY 1,980** (1,800)  
Short, loose, 175 sticks, 13.5 cm



## Kyozakura

— Kyoto Cherry Blossoms

A sandalwood-based fragrance to tempt you into visions of cherry blossoms in spring.

**122605** **JPY 2,750** (2,500)  
Short, loose, 490 sticks, 13.5 cm

**122608** **JPY 1,430** (1,300)  
Short, loose, 175 sticks, 13.5 cm



## Kinkaku — Golden Pavilion

A refreshing sandalwood fragrance inspired by the Golden Pavilion reflected on the pond.

**122505** **JPY 2,200** (2,000)  
Short, loose, 490 sticks, 13.5 cm

**122508** **JPY 1,100** (1,000)  
Short, loose, 175 sticks, 13.5 cm



## Kyonishiki

— Kyoto Autumn Leaves

A quiet fragrance of sandalwood gives rise to images of autumn leaves in Arashi-yama, Kyoto.

**122405** **JPY 1,650** (1,500)  
Short, loose, 490 sticks, 13.5 cm

**122408** **JPY 880** (800)  
Short, loose, 150 sticks, 13.5 cm



## Nokiba — Moss Garden

A mild fragrance of sandalwood that smells like plum flowers blooming by the windows.

**122305** **JPY 2,200** (2,000)  
Short, loose, 490 sticks, 13.5 cm

**122308** **JPY 1,100** (1,000)  
Short, loose, 150 sticks, 13.5 cm

# LOW SMOKE INCENSE

Our master blenders designed these scents to enhance any occasion with a spiritual nuance of fragrance.



## Oboro — Illusions

A noble and savory fragrance, made from selected herbs and spices.

**126213** **JPY 4,400** (4,000)  
Short, loose - 470 sticks, 13.5 cm

**126283** **JPY 2,200** (2,000)  
Short, loose - 165 sticks, 13.5 cm



## Kasumi — Gossamer

A subtly bitter fragrance of sandalwood mixed with high quality herbs and spices.

**126212** **JPY 3,300** (3,000)  
Short, loose - 470 sticks, 13.5 cm

**126282** **JPY 1,650** (1,500)  
Short, loose - 165 sticks, 13.5 cm



## Honoka — Silhouette

A mild, sweet fragrance of sandalwood with herbs and spices.

**126211** **JPY 2,200** (2,000)  
Short, loose - 470 sticks, 13.5 cm

**126281** **JPY 1,100** (1,000)  
Short, loose - 165 sticks, 13.5 cm



## Madoka — Chiffon

A gentle low-smoke blend with a sweet, heart-warming accent, featuring sandalwood, cinnamon, and herbs.

**126210** **JPY 1,650** (1,500)  
Short, loose - 470 sticks, 13.5 cm

**126280** **JPY 825** (750)  
Short, loose - 165 sticks, 13.5 cm



# LOW SMOKE INCENSE

玉  
tamayura  
響音

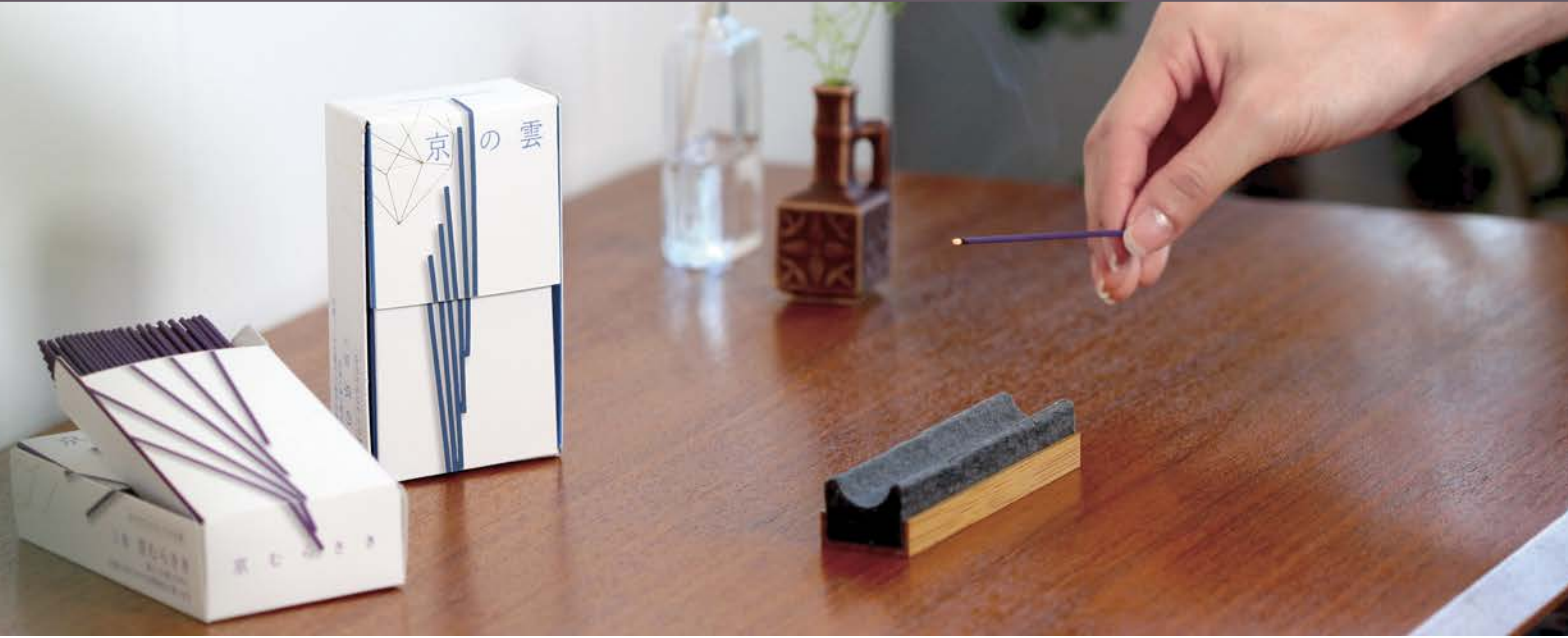

TAMAYURA -Embrace an enchanting moment, immersed in delicate, fine fragrance.  
Low Smoke & delicate scent.



## Kyo-no-kumo

Elegant and mature scent of Aromatic wood, Agarwood bases.

126307 JPY 2,750 (2,500)  
45g (Approx.200 sticks), 9 cm,  
with a holder



## Kyo-murasaki

Soothing scent of Aromatic wood, Agarwood bases.

126306 JPY 2,200 (2,000)  
45g (Approx.200 sticks),  
9 cm, with a holder



## Kyo-matsuba

Fresh aroma reminiscent of pine tree.

126305 JPY 1,650 (1,500)  
45g (Approx.200 sticks),  
9 cm, with a holder



## Kyo-no-ume

Be enchanted with Modest and sweet fragrance.

126304 JPY 1,320 (1,200)  
45g (Approx.200 sticks),  
9 cm, with a holder



## Kyo-hiyori

A clean and refreshing fragrance reminiscent of a sunny breeze.

126303 JPY 1,100 (1,000)  
45g (Approx.200 sticks), 9 cm,  
with a holder

Practical & smart design packaging.



TRAY ▶P.16 takuba 11cm

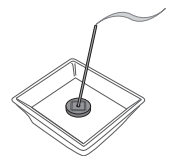

### Eco-friendly disposable incense holder

Avoid strong impact or exposure to water since it is made of soil.

Named after periods and places in Japanese history, our line of Horin incense offers a modern twist on the ancient art of incense appreciation. Perfect for galleries, large rooms and musical events.



### Tenpyo — Peaceful Sky

A noble Japanese fragrance; deep, natural.

- 210521 **JPY 6,600** (6,000)  
10 coils, with a holder
- 210523 **JPY 2,200** (2,000)  
20 sticks, 7 cm, with a holder
- 210524 **JPY 6,600** (6,000)  
80 sticks, 7 cm, with a holder



### Muromachi — City of Culture

A solemn and calming fragrance.

- 210421 **JPY 3,960** (3,600)  
10 coils, with a holder
- 210423 **JPY 1,540** (1,400)  
20 sticks, 7 cm, with a holder
- 210424 **JPY 4,620** (4,200)  
80 sticks, 7 cm, with a holder



### Horikawa — River Path

Sweet and mellow fragrance, based on sandalwood.

- 210221 **JPY 3,080** (2,800)  
10 coils, with a holder
- 210223 **JPY 1,100** (1,000)  
20 sticks, 7 cm, with a holder
- 210224 **JPY 3,300** (3,000)  
80 sticks, 7 cm, with a holder



### Genroku — Returning Spirit

Enjoy this rich, sandalwood-based fragrance.

- 210321 **JPY 2,860** (2,600)  
10 coils, with a holder
- 210323 **JPY 990** (900)  
20 sticks, 7 cm, with a holder
- 210324 **JPY 2,970** (2,700)  
80 sticks, 7 cm, with a holder



### Shirakawa — White River

A soft and sweet fragrance, based on sandalwood.

- 210621 **JPY 1,870** (1,700)  
10 coils, with a holder
- 210623 **JPY 880** (800)  
20 sticks, 7 cm, with a holder
- 210624 **JPY 2,420** (2,200)  
80 sticks, 7 cm, with a holder



### Nijo — Avenue of the Villa

A traditional fragrance of sandalwood, with a flowery note.

- 210121 **JPY 1,320** (1,200)  
10 coils, with a holder
- 210123 **JPY 660** (600)  
20 sticks, 7 cm, with a holder
- 210124 **JPY 1,870** (1,700)  
80 sticks, 7 cm, with a holder



### Kyogosai

— Horin Sticks Assortment

Nijo, Shirakawa, Genroku, Muromachi, Tenpyo - each 4 sticks.

- 211012 **JPY 1,650** (1,500)  
20 sticks, 7 cm, with a holder

Seven fragrances to evoke the memories of a journey; scenery, sound, light, and all you encountered along the way.



## Nanzan

— Southern Mountain

The best Frankincense ever used in an incense stick. Mellow and warm.

212126 JPY 935 (850)  
20 sticks, 7 cm, with a holder  
212125 JPY 2,750 (2,500)  
80 sticks, 7 cm, with a holder



## Kaho

— Flower Garden

A rich, yet bittersweet fragrance of radiant flowers.

211526 JPY 935 (850)  
20 sticks, 7 cm, with a holder  
211525 JPY 2,750 (2,500)  
80 sticks, 7 cm, with a holder



## Yukiyanagi

— Spring Blossoms

Ambrosial notes of a blooming spring garden.

211626 JPY 935 (850)  
20 sticks, 7 cm, with a holder  
211625 JPY 2,750 (2,500)  
80 sticks, 7 cm, with a holder



## Kanro

— Sweet Dew

The luscious fragrance of a clear autumn morning.

212026 JPY 935 (850)  
20 sticks, 7 cm, with a holder  
212025 JPY 2,750 (2,500)  
80 sticks, 7 cm, with a holder



TRAY ▶P.15  
Incense Tray Cream

80 sticks



## Sou sou

— Rustling Meadow

Atmospheric scent blanketing green fields.

211726 JPY 935 (850)  
20 sticks, 7 cm, with a holder  
211725 JPY 2,750 (2,500)  
80 sticks, 7 cm, with a holder



## Sougetsu

— Moon Reflection

A wafting scent of fresh flowers, heralding a new season.

211826 JPY 1,100 (1,000)  
20 sticks, 7 cm, with a holder  
211825 JPY 3,300 (3,000)  
80 sticks, 7 cm, with a holder



## Yoinouta — Poetry at Dusk

The enchanting fragrance of aromatic wood, floating delicately in the early evening.

211926 JPY 1,100 (1,000)  
20 sticks, 7 cm, with a holder  
211925 JPY 3,300 (3,000)  
80 sticks, 7 cm, with a holder



## KUNRO ASSORTMENT

— Assortment of seven fragrance

Nanzan, Kaho, Yukiyanagi, Kanro, Sou sou, Sougetsu, Yoinouta - each 4 sticks.

211402 JPY 1,980 (1,800)  
28 sticks, 7 cm, with a holder

Using our exclusive pressed incense process, Shoyeido's master blenders have developed the Xiang Do line of atmospheric incenses. Here are 16 of beautiful fragrances - at once evocative, lush, and crowd-pleasing.



## Xiang Do

JPY 880 (800)

20 sticks, 7 cm, with a holder



**Rose**

214502



**Lotus**

214505



**Lavender**

214508



**Citrus**

214522



**Grapefruit**

214527



**Mixed berry**

214532



**Forest**

214541



**Vanilla**

214545



**Peppermint**

214547



**White Sage**

214548



**Marine**

214558



**Frankincense**

214563



**Agarwood**

214573



**Sandalwood**

214576



**Palo santo**

214579



**Hinoki**

214580



## Xiang Do Assortment

214402

JPY 2,640 (2,400)

32 sticks (2 sticks each of 16 scents)  
7 cm, with a holder

# FLORAL WORLD

## FLORAL WORLD INCENSE ASSORTMENT

In the 1890s, SHOYEIDO developed Floral World cone-shaped incense in an effort to introduce Japanese incense to the world, thus becoming the first company in Japan to successfully export incense to the United States. Since that time, Floral World incense has continued to evolve and change, while being cherished by many people along the way. Once again, change is in store for this popular line of incense. We welcome you to enjoy these six rich fragrances, which evoke the lovely scent of a bouquet of flowers.

六種  
花  
世  
界



<b>RED</b>	<b>PURPLE</b>	<b>BLUE</b>	<b>GREEN</b>	<b>LIME GREEN</b>	<b>YELLOW</b>
Rose	Lavender	Iris	Sandalwood	Jasmine	Freesia

TRAY ▶P.15  
Incense Tray Cream



### FLORAL WORLD Incense Assortment - Cone

**220112** JPY 2,750 (2,500)  
30 pcs. (5 pcs. each of 6 scents),  
with a holder

### FLORAL WORLD Incense Assortment - Stick

**220111** JPY 2,750 (2,500)  
60 sticks (10 sticks each of 6 scents),  
7 cm, with a holder

## FLORAL WORLD

Singular scent pack is available for each kind.  
Each scent is available in a unique package



### Rose

**Stick**  
**220131** JPY 2,750 (2,500)  
60 sticks, 7 cm, with a holder

**Cone**  
**220132** JPY 2,750 (2,500)  
30 pcs., with a holder

### Iris

**Stick**  
**220161** JPY 2,750 (2,500)  
60 sticks, 7 cm, with a holder

**Cone**  
**220162** JPY 2,750 (2,500)  
30 pcs., with a holder

### Jasmine

**Stick**  
**220181** JPY 2,750 (2,500)  
60 sticks, 7 cm, with a holder

**Cone**  
**220182** JPY 2,750 (2,500)  
30 pcs., with a holder



### Lavender

**Stick**  
**220141** JPY 2,750 (2,500)  
60 sticks, 7 cm, with a holder

**Cone**  
**220142** JPY 2,750 (2,500)  
30 pcs., with a holder

### Sandalwood

**Stick**  
**220171** JPY 2,750 (2,500)  
60 sticks, 7 cm, with a holder

**Cone**  
**220172** JPY 2,750 (2,500)  
30 pcs., with a holder

### Freesia

**Stick**  
**220191** JPY 2,750 (2,500)  
60 sticks, 7 cm, with a holder

**Cone**  
**220192** JPY 2,750 (2,500)  
30 pcs., with a holder



# 源氏物語抄



The legendary Japanese story The Tale of Genji is one of the world's profound cultural achievements. Written by the Lady Murasaki in the early 11th Century as entertainment for the Empress Akiko, this thousand - year - old masterpiece lays claim to many literary firsts : the world's first true novel.

The first psychological novel. The first historical novel. The Tale of Genji is a window into a bygone world, providing a glimpse into the Japan of a millennium ago.

With The Genji Series, Shoyeido is pleased to evoke the scenes and sublime beauty of The Tale of Genji.



**Utakata**  
— Transient Dream

623601 JPY 2,200 (2,000)  
20 sticks, 7 cm (4 scents, 5 of each),  
with a holder



**Hahakigi**  
— Beauty

621720 JPY 2,200 (2,000)  
20 sticks, 7 cm (4 scents, 5 of each),  
with a holder



**Hanachirusato**  
— Field of Blossoms

620951 JPY 1,100 (1,000)  
20 sticks, 7 cm, with a holder

# INCENSE HOLDER



**New Spring**  
– Hatsuharu  
734501



**Plum Blossoms**  
– Umemi  
734502



**Cherry Blossoms**  
– Hanasaki  
734503



**White Lilac**  
– Unohana  
734504



**Stream**  
– Sanae  
734505



**Kingfisher**  
– Ryobo  
734506



**Morning Glory**  
– Tanabata  
734507



**Moon Viewing**  
– Tsukimi  
734508



**Autumn Ivy**  
– Momiji  
734509



**Small Chrysanthemum**  
– Shigure  
734510



**Winter Peony**  
– Shimofuri  
734511



**White Rabbit**  
– Harumachi  
734512



**Pine Tree**  
– Matsu  
736401  
★ EXPORT-ONLY



**Plum**  
– Umebachi  
736402  
★ EXPORT-ONLY



**Wave**  
– Nami  
736403  
★ EXPORT-ONLY



**Purple**  
735875



**White**  
735874



**Yellow**  
735873



**Red**  
735872



**Green**  
735871

## Incense Holder Wedge

JPY 550 (500)  
Size: 35mm



**Purple**  
735885



**White**  
735884



**Yellow**  
735883



**Red**  
735882



**Green**  
735881

## Incense Holder Gourd

JPY 550 (500)  
Size: 35mm

## Precautions for using Incense Holder

Please stick incense into a holder, and securely stand it leaning in the direction of the holder's thicker part. Incense can fall if it is stood wrong.

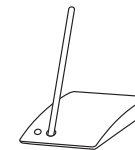

## Porcelain Incense Holder

JPY 660 (600)

Square	W 3.5 x H 3.5 cm
Octagon	W 3.5 x H 3.5 cm
Circle	W 4.0 x H 3.5 cm
Rectangle	W 4.0 x H 3.0 cm
Oval	W 5.5 x H 2.8 cm

# INCENSE HOLDER

## Incense Holder nana

This product is shaped as the numeral "7". In Japanese, "Nana" is the pronunciation for the number 7. Depending on the shape and style of your incense burner, users can attach this holder on the rim of a small bowl, or place it on a plate.



736515  
JPY 2,420 (2,200)  
Material: Zinc Alloy



2 ways by hanging it on rim of a bowl



5 ways by putting it on a plate

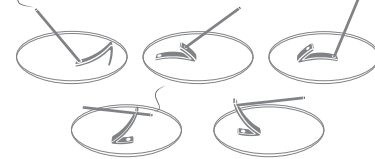

## Brass Incense Holder

736524  
JPY 660 (600)  
19mm



## Tweezers

736501  
JPY 3,960 (3,600)  
Material: Stainless, Rattan  
W 1.3 x L 8.5 x H 1.1 cm



2 ways for use



Easy to ignite short incense sticks.



Hold incense at any point. The length to burn can be adjusted.



## Kolip Shell Matte Silver

[Kolip : Koh(Japanese Incense)+Clip]

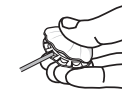

-How to hold incense -

Open the shell, grasping the bulging part softly with the pad of your fingers. Secure the incense into one of the five recesses on the shell, and fasten it.  
\*Use with a tray made from heat-resistant material to catch the ash.



731343  
JPY 3,300 (3,000)  
W 3.8 x H 2.3 cm

# INCENSE TRAY

## Square Porcelain Incense Tray

JPY 770 (700)  
W 10 x H 10 cm



**Cream**  
736113



**Light Blue**  
736112



**Dark Blue**  
736111



## Incense Tray Black

737101  
W 10 x H 10 cm  
Porcelain  
★ EXPORT-ONLY

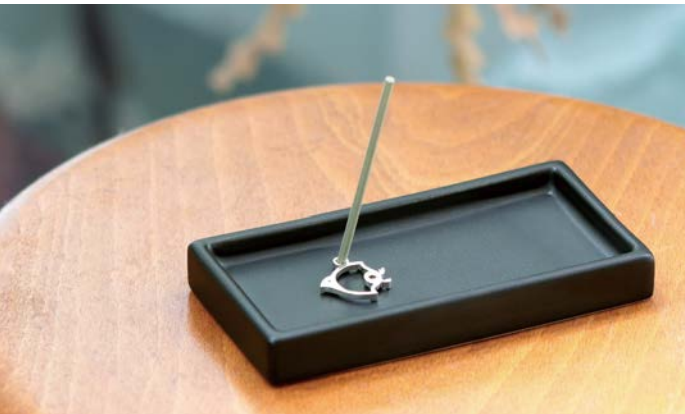

## Incense Tray Nagate

JPY 858 (780)  
W 12.3 x H 6.3 cm  
Porcelain

A simple and adorable tray for incense. It can be enjoyed with your favorite holder and fragrance.



**White**  
736351



**Black**  
736354



## Incense Tray takuba

"Takuba" is a simple and practical incense tray, which allows the user to burn an entire stick of incense, while leaving no unused portion when the stick is done burning. After use, it is simple and easy to clear the tray to be used again.

Available in 3 length variations.

Contents:  
1x Ceramic felt tray with  
Bamboo cover,  
1x Replacement Ceramic felt tray.



**takuba 9cm**  
736505  
Usable Incense stick length: Under 7cm  
W 9 x H 2.8 cm  
JPY 4,070 (3,700)



**takuba 11cm**  
736510  
Usable Incense stick length: Under 9cm  
W 11 x H 2.8 cm  
JPY 4,400 (4,000)



**takuba 19cm**  
736506  
Usable Incense stick length: Under 18cm  
W 19 x H 2.8 cm  
JPY 5,170 (4,700)



# INCENSE BURNER



**Karakusa**  
- Arabesque

731101  
JPY 3,300 (3,000)  
W 7.8 x H 4.8 cm  
/ ▲ ◎



**Senbiki**  
- Lines

731102 JPY 3,300 (3,000)  
W 7.8 x H 4.8 cm  
/ ▲ ◎

**Miyuki**

JPY 6,050 (5,500)  
W 6.7 x H 6.2 cm

/ ▲ ◎



**Ishidatami**  
- Stone Pavement

718110



**Nijumaru**  
- Double Circle

718109



**Ginsen**  
- Silver Lines

718105



**Seiji**  
- Light Blue

718101

Usable shape of incense :  
/ stick ▲ cone ◎ coil

# COVERED TYPE INCENSE BURNER



## Little Bird

720110  
JPY 4,180 (3,800)  
H 9.4 cm  
/ ▲



## Child Guardian

720183 JPY 5,280 (4,800)  
H 14 cm  
/ ▲



## Small Cat

720184 JPY 4,180 (3,800)  
H 10 cm  
/ ▲



## Matroos

720108 JPY 7,590 (6,900)  
H 17 cm  
/ ▲



## HONOKA

720106 JPY 7,700 (7,000)  
H 18.8 cm  
▲



## Owl

720141 JPY 5,280 (4,800)  
H 12 cm  
/ ▲ ◎



## Small Owl

720146 JPY 3,960 (3,600)  
H 9 cm  
/ ▲



Usable shape of incense :

/ stick ▲ cone ◎ coil

# INCENSE CENSER



**Nawame - Green**

724911 JPY 2,200 (2,000)  
W 8.5 x H 4.5 cm



**Nawame - White**

724912 JPY 2,200 (2,000)  
W 8.5 x H 4.5 cm



**Shiro**  
724923

JPY 6,050 (5,500)  
W 7 x H 8.2 cm



**Sumi**  
724981

JPY 6,050 (5,500)  
W 7 x H 8.2 cm



**Lantern**

724201 JPY 3,850 (3,500)  
W 6.5 x H 9 cm



**Nanban Style**

724211 JPY 5,500 (5,000)  
W 6 x H 9 cm



**Oribe Green**

724921 JPY 6,600 (6,000)  
W 6.5 x H 9.5 cm



**Orange Blossoms**

724501 JPY 13,200 (12,000)  
W 6 x H 9 cm



**Tinted Ivy**

724503 JPY 13,200 (12,000)  
W 5.8 x H 8.5 cm



**Moonflower**

724504 JPY 13,200 (12,000)  
W 5.8 x H 8.5 cm



**Cloisonne**

724506 JPY 44,000 (40,000)  
W 5.8 x H 9.5 cm



## How to use Incense Censer

Remove the lid and place Miyako Ash in to the incense censer. Light the tip of the incense and fan out of the fire flame. Insert the stick incense in to the ash or place coil/cone incense on the ash.

\* We recommend removing the lid while burning incense. In many cases the lid will restrict the flow of oxygen and can extinguish the incense.



**Miyako Ash**

751101 JPY 275 (250)  
Use with  
incense censer  
30 g

# TAGASODE SACHET

Sachets are Non-burning incense items which release a fragrance in its natural, unheated state.

Historically, Japanese fragrant sachets have consisted of a plain or brocade cloth bag with "Nioi-koh" - a powdered mix of natural ingredients such as clove, camphor and sandalwood - inside.

Shoyeido's fragrant sachets continue this long-held style.

Following 300-year-old recipes, Shoyeido's traditional sachets are available in colorful cloth, brocade and paper envelopes. They can be used in a pocket, on a purse, or in drawers, closets, suitcases, cars, etc. They add a subtle fragrance of sandalwood and herbs.

Premium Quality - Mild sweet fragrance

Extra Fine Quality - Refreshing fragrance



**Miyako**

512111 JPY 1,045 (950)  
H 6 cm



**Kaoru**

511211 JPY 1,045 (950)  
H 6 cm  
Kyoto Nishijin silk Pouch



**Gokuhin**

511111 JPY 825 (750)  
H 6 cm

Fine Quality - Refined, clean fragrance



**Johin**

510111  
JPY 715 (650)  
H 5 cm



**Fukube**

510140 JPY 550 (500)  
H 5.5 cm

Colors



Utsusemi - Sweet and fresh fragrance

Nio - Clean, slightly bitter fragrance



**Utsusemi**

620440 JPY 440 (400)  
W 5.5 x H 8.5 cm



**Nio**

624901 JPY 440 (400)  
W 5.5 x H 8.5 cm



In a closet

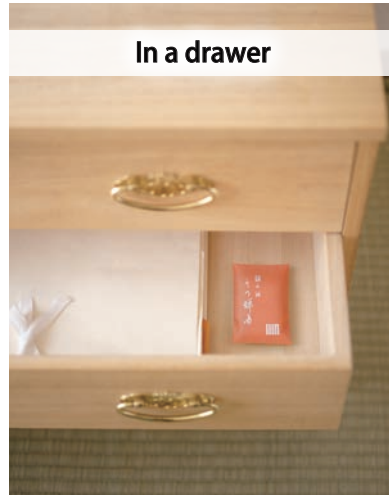

In a drawer



In a Bathroom

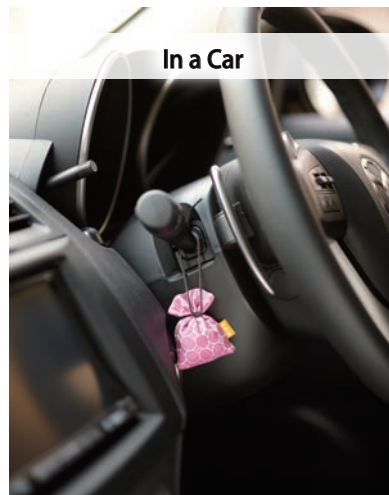

In a Car

Fragrant sachet is appropriate for use in a car, closet or in a bag to give your clothing

# HANGING SACHET



## Flower Wheel

514151 JPY 1,045 (950)

W 7.5 cm

Colors: Red, Purple, Black, Pink, Light Blue and Beige



## Sachet

The beautifully designed Japanese traditional pattern adds an aesthetic highlight.

\*The pattern and color are selected randomly.

## How to use

Will hang appropriately on any closet bar or hanging apparatus that is less than 35mm in outside diameter. It is also effective to enliven a restroom or any personal space.

## Tagasode -Kakeru-

Tagasode Kakeru, the fragrant hanging sachet, emits a pleasant fragrance that is appropriate for use in closets to give clothing a refreshing scent. It is also effective to enliven a restroom or any personal space.

JPY 1,045 (950)

W 7.2 × H 16.8 cm



Black  
519512

Beige  
519511



# INCENSE FOR MIND AND ATMOSPHERE

It is widely believed that incense was brought to Japan over 1400 years ago, along with the conveyance of Buddhism.

Historically, Japanese Incense has often been cherished and used for religious occasions, in the social routine of samurai warriors, and more.

During the Edo period, incense became popular among all classes, as it was established as a tradition for all Japanese culture.

Centuries later, the Japanese style of living has changed but the appreciation and pride for incense in Japanese culture remains the same. We are pleased to convey the concept of “life with fragrance” to our customers.



**SHOYEIDO INCENSE CO.**

Karasuma Nijo, Nakagyo-ku, Kyoto 604-0857 Japan

TEL : +81-75-212-5590 FAX : +81-75-212-5595

[www.shoyeido.co.jp](http://www.shoyeido.co.jp)

**Shoyeido USA, Inc.**

1700 38th St., Boulder, CO 80301 U.S.A.

TEL : +1-800-786-5476

[www.shoyeido.com](http://www.shoyeido.com)